

# INTRODUCING the redesigned



**Chill-Out Chairs** alternative seating system can help improve the user's positioning, providing the benefit of reduced transfers throughout the day and a comfortable seating experience. It features the redesigned, more defined reclined angle that aids in the reduction and easing of kyphosis of the user.

## Four-Step Order Process:

1. Select style and size.
2. Select foam package and fabric.
3. Choose accessories and foam warranty.
4. Call our team if you have any questions.

1-800-661-9915 or visit [chill-outchair.com](http://chill-outchair.com)

## Rock'er

Known for its adjustable tilt and calming rocking motion, the Rock'er can improve the alignment of users of all ages and abilities, while redistributing pressure.



## Roll'er

With a rolling wheelbase, the Roll'er can reduce the number of transfers required throughout the day – perfect for home, school or therapy settings.

The Chill-Out Chair comes standard with a multi-purpose ottoman and multi-use modular support wedge, covered in matching fabric.

## Sizing and Dimensions: Recommended User Size Ranges / Chair Dimensions

| Chill-Out Chair Size | Height Range (inches) | Height Range (cm) | Weight Range (lbs) | Weight Range (kg) | Overall Length (A) | Overall Height (B) | Overall Width (C) | Seat Width (#1) | Seat Depth (#2) | Seat Back Height (#3) | Rock'er Weight (lbs) *** | Roll'er Weight (lbs) *** |
|----------------------|-----------------------|-------------------|--------------------|-------------------|--------------------|--------------------|-------------------|-----------------|-----------------|-----------------------|--------------------------|--------------------------|
| Small                | 40" - 52"             | 102 - 132         | 30 - 80            | 14 - 36           | 29"                | 33"                | 19"               | 12"             | 12"             | 26"                   | 21                       | 30                       |
| Medium               | 50" - 62"             | 127 - 157         | 55 - 120           | 25 - 54           | 34"                | 36"                | 21"               | 14"             | 14"             | 31"                   | 26                       | 37                       |
| Narrow Large         | 60" - 68"             | 152 - 173         | 70 - 155           | 32 - 70           | 40"                | 41"                | 22"               | 14"             | 16"             | 38"                   | 33                       | 42                       |
| Large                | 60" - 68"             | 152 - 173         | 90 - 175           | 41 - 79           | 40"                | 41"                | 24"               | 16"             | 16"             | 38"                   | 36                       | 46                       |
| Extra-Wide Large     | 60" - 68"             | 152 - 173         | 175 - 300          | 79 - 136          | 40"                | 46"                | 31"               | 21"             | 17"             | 38"                   | 46                       | 56                       |

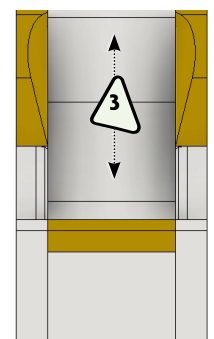
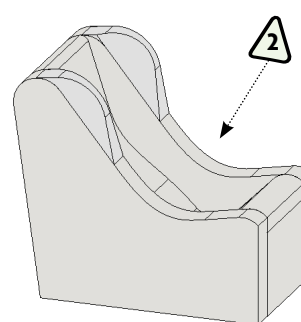
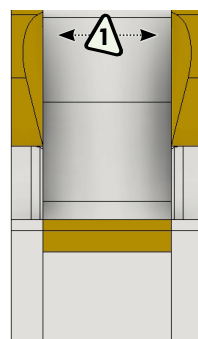

## User Information

User Name: \_\_\_\_\_

Date of Birth: Month \_\_\_\_\_ / Day \_\_\_\_\_ / Year \_\_\_\_\_

Height: \_\_\_\_\_ / INCHES \_\_\_\_\_ / CM \_\_\_\_\_ / Weight: \_\_\_\_\_ LBS \_\_\_\_\_ / KG \_\_\_\_\_

Shoulder Width: \_\_\_\_\_ / INCHES \_\_\_\_\_ / CM \_\_\_\_\_ Shoulder Width: \_\_\_\_\_ INCHES \_\_\_\_\_ / KG \_\_\_\_\_

Diagnosis: \_\_\_\_\_

## Select Your Model (check selection)

|         | SMALL        | MEDIUM       | NARROW LARGE  | LARGE        | EXTRA WIDE LARGE |
|---------|--------------|--------------|---------------|--------------|------------------|
| Rock'er | (COCROCKRSM) | (COCROCKRMD) | (COCROCKRNLG) | (COCROCKRLG) | (COCROCKRXLGW)   |
| Roll'er | (COCROLLRSM) | (COCROLLRMD) | (COCROLLRNLG) | (COCROLLRLG) | (COCROLLRXLGW)   |

## Select Your Foam Package (check selection)

|   | SMALL                         | MEDIUM                        | NARROW LARGE                  | LARGE                         | EXTRA WIDE LARGE     |
|---|-------------------------------|-------------------------------|-------------------------------|-------------------------------|----------------------|
| Essential<br>(Included with base price) | <b>No Charge</b><br>(3640121) | <b>No Charge</b><br>(3640321) | <b>No Charge</b><br>(3640521) | <b>No Charge</b><br>(3640421) | <b>Not Available</b> |
| TEC Foam Package                        | (3640125)                     | (3640325)                     | (3640525)                     | (3640425)                     | (3640625)            |

| Essential Foam Package   | TEC Foam Package<br>(Therapists'/Educators Choice)  |
|--|---|
| Essential Foam Package is made of one density to offer great comfort and support for those 100lbs or less.<br><b>Included in base price of Chill-Out Chair</b> | Provides soft comfort, firm support and best durability for all user weights. It features softer foam under the knees and beside the headrest to increase comfort and eliminate pressure points. Recommended for heavier users. |
| Standard One-Year Warranty   | Standard Three-Year Warranty  |

## Ottomans (check selection) **One selection required.**

|   |   |   |
|---|---|---|
|    |               |                        |
| <b>Regular Ottoman</b><br>SM (PART NUMBER)<br>MED- LG (PART NUMBER)<br>XWLG (PART NUMBER)<br><b>STD</b><br><i>*Recommended for our full extension users</i> | <b>45 Degree Ottoman</b><br>(3640313)<br><i>*Recommended for limited knee/leg extension users</i> | <b>Step Platform Ottoman</b><br>(3640314)<br><i>*Recommended for limited or no knee/leg extension users</i> |

PAGE SUB-TOTAL \_\_\_\_\_

## Select Your Fabric (check selection)

**Spirit Series:** Buttery soft, easy to wipe vinyl fabrics. Endurepel™ Armour topcoat protection provides an easy clean finish that has anti-bacterial and anti-mildew properties.



**Spirit, Prairie and Seaside fabrics are included with the base price of your chair.**

**Prairie Series:** Woven fabrics with a soft, dry hand and lots of visual, stylish texture. Treated with Endurepel™ Shield offering anti-stain and moisture repellent technology, combined with easy clean and odor protection properties.



**Seaside Series:** Soft and comfortable distressed suede like fabrics. Treated with Endurepel™ Shield offering anti-stain and moisture repellent technology, combined with easy clean and odor protection properties.

## Premium Fabrics: (check size and fabric)

**Escape Series:** Patterned and solid, intricately textured fabrics. Durable, anti-microbial and built for indoor and outdoor use. SolarShade fabrics are created with high UV rating, water repellency and anti-microbial technology.



- Small ..... (9640221)
- Medium ..... (9640321)
- Narrow Large ..... (9640521)
- Large ..... (9640421)
- Extra Wide Large ..... (9640621)



## Select Your Color Combination (optional) Only available in the Spirit Series.



Color combination (COLORCOMBO)

Please indicate primary Spirit fabric:

---

Please indicate secondary Spirit fabric:

---

PAGE SUB-TOTAL

# Accessories (check selection)

|                                      | SMALL     | MEDIUM    | NARROW<br>LARGE | LARGE     | EXTRA WIDE<br>LARGE |
|--------------------------------------|-----------|-----------|-----------------|-----------|---------------------|
| <b>Occiput Headrest</b>              | (2640106) | (2640306) | (2640306)       | (2640406) | (2640406)           |
| <b>Activity Wedge</b>                | (2644031) | (2644032) | (2644034)       | (2644033) | (2644035)           |
| <b>Memory Foam Liner</b>             | (3640190) | (3640390) | (3640590)       | (3640490) | (3640690)           |
| <b>Medbloc Liner</b>                 | (2640110) | (2640310) | (2640510)       | (2640410) | (2640610)           |
| <b>3-Piece Foam Positioning Aids</b> | (2040750) | (2040751) | (2040751)       | (2040752) | (2040753)           |
| <b>5-Point Chest Harness</b>         | (2141071) | (2141072) | (2141073)       | (2141073) | (2141074)           |

New!



**Occiput Headrest**  
Provides targeted support for the neck and head. Can be adjusted to allow for growth.



**3-Piece Foam Positioning Aids**  
Increase support and positioning with our foam positioning aids. *Includes the new Multi-Use Modular Support Wedge!*



**Activity Wedge**  
Encourages upright positioning.



**Medbloc Liner**  
Heat-sealed liner that prevents moisture seepage and protects the hygienic integrity of the foam.



**Memory Foam Liner**  
Adds an extra layer of foam for comfort.



**5-Point Chest Harness**  
Increase support and positioning while holding the user in the chair securely.

**3-Point Pelvic Positioning Belt**  
Our 3-Point Padded Pelvic Positioning Belt is great for pelvic stabilization and safety, keeping the hips back in the chair.



(2640041)

**Large Accessories Sleeve Pocket**  
Keep all positioning aids at the ready when not in use with the Accessories Sleeve Pocket.  
*Ideal for storing positioning pads.*



(2640090)



**Removable Abduction Pommel**  
The Removable Abduction Pommel sits between the user's legs to help encourage hip abduction. The pommel is attached to the Chill-Out Chair with strong velcro straps and can be removed as desired.

SML (2640047)  
MED-LG (2640048)



**Feeding/Activity Tray**  
Perfect for feeding, play or communication, the Feeding and Activity Tray is the ideal accessory to assist with individual development.

*\*Roll'er Chair only  
XW-LG measures 35" across*

SM - LG (2040051)  
XWLG (2040052)



**Pushbar**  
Our Pushbar makes moving the Roll'er Chair from room-to-room effortless, resulting in less transfers in-and-out of the chair.

*\*Roll'er Chair only*

(2040055)



**Small Accessories Sleeve Pocket**  
Store your portable electronics, adaptive communication devices, and video players right with your chair.

*Always have them at hand!*

(2040053)

PAGE SUB-TOTAL



### Ottoman Support Kit

Our ottoman support kit with multi height ottoman keeps the ottoman off the ground and allows you to roll your Chill-Out Chair with the ottoman in place.

*\*Not available in XW-LRG  
\*Roll'er Chair only*

(2040090)



### Transport Chair Cover

Bring your Chill-Out Chair wherever you go with the Transport Chair Cover that fits over both the chair and ottoman when placed on the seat. Prevents damage and protects integrity of chair when transporting.

Small-Large (6340700)  
XWide Large (6340702)



### Rocking Base for Roll'er Chair

Turn your Roll'er model into a Rock'er! Roll the Roll'er model onto the track for back-and-forth tilting motion or to add fixed tilt to the chair.

*Please note, the Rocking Base requires our Ottoman Support Kit. Some assembly required.*

*\*Not available in Small or Extra Wide Large.*

Medium (2040041)  
Narrow Large (2040042)  
Large (2040043)

## Foam Warranty

| WARRANTY PACKAGE                      | ESSENTIAL FOAM | TEC FOAM    |
|---------------------------------------|----------------|-------------|
| <b>ADDITIONAL One Year Warranty</b>   | (WARR_1YR)     | (WARR_1YR)  |
| <b>ADDITIONAL Three Year Warranty</b> | (WARR_3YR)     | (WARR_3YR)  |
| <b>LIFETIME Warranty</b>              | N/A            | (WARR_LIFE) |

## Customizations



## Terms & Conditions

Prices and fabric colors are subject to change without notice. Prepaid or net 30 days O.A.C. All taxes extra. Freight extra. Manufacturer reserves the right to change prices, colors, features, dates, locations and products without notice. Residential delivery charge may apply. Duty and brokerage included where applicable.

CUSTOMER SIGNATURE

## Photo Release

I hereby give permission to Freedom Concepts Inc. to use photographs of me or my child for the sole purpose of the company's promotional use, and will not be distributed to third parties. .... **Yes** **No**

I would like to receive regular updates. .... **Mail** **Email** **No**

SIGNATURE OF OCCUPANT/PARENT

## Order Information

Order Date: \_\_\_\_\_ Quote Date: \_\_\_\_\_

Chill-Out Representative: \_\_\_\_\_

Payment Terms: \_\_\_\_\_

CREDIT CARD (CHECK ONE) Visa MasterCard Exp. Date: \_\_\_\_/\_\_\_\_/\_\_\_\_

Card Number: \_\_\_\_\_

Name On Card: \_\_\_\_\_

Shipping Address: \_\_\_\_\_

Prov/State: \_\_\_\_\_ City: \_\_\_\_\_

Postal/Zip Code: \_\_\_\_\_ Federal ID/SS#: \_\_\_\_\_

## Privacy Policy

Freedom Concepts Inc. collects, uses and discloses personal information of the Customer and/or Rider to properly assemble and manufacture the mobility device and may contact the Rider's therapist for additional personal information to assist with this process. The collection, use and disclosure of the personal information of the Customer and/or the Rider is governed by any consent which may, from time to time, be provided, and by the Freedom Concepts Inc. Privacy Policy which is available on our website [www.freedomconcepts.com](http://www.freedomconcepts.com) or by contacting our office. By signing below, you hereby warrant that you have the authority to bind the Rider and hereby authorize the collection, use, and disclosure of personal information as herein provided and in accordance with the Freedom Concepts Inc. Privacy Policy.

|                |  |
|----------------|--|
| Total - Page 2 |  |
| Total - Page 3 |  |
| Total - Page 4 |  |
| Sub-Total      |  |
| Discount       |  |
| Tax 1          |  |
| Freight        |  |
| Other          |  |
| <b>TOTAL</b>   |  |